

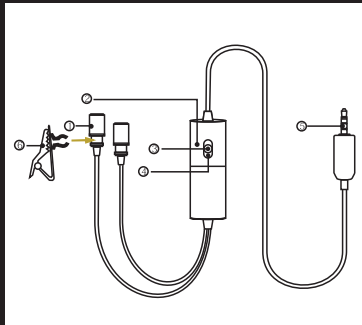

# HYDRA

DUAL MOSQUITO  
MICROPHONE

**SVIVE®**



1. Omni-directional microphone
2. Battery Compartment
3. ON/DSLRCamcorders etc.
4. OFF/Smartphone
5. 3.5 mm [1/8"] gold 4-pole mini-plug
6. Clamp the clip on the concave of microphone

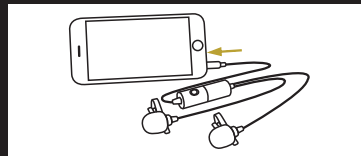

## USING THE MICROPHONE

- Passive microphone mode (for mobile phone only), slide the ON/OFF down to OFF/Passive mode and you can use it to record the audio without power supply.
- Active microphone mode (for DSLR, PC, GoPro etc.). Slide the ON/OFF up to ON/Active mode and you can use it to record the audio with power on.

## HOW TO ACCESS BATTERY



Unscrew the  
battery case



Insert the  
battery case

## SPECIFICATIONS

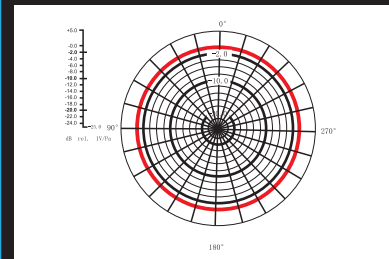
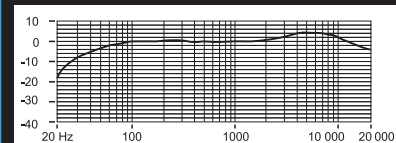

Imported by Svive, Østre Kullerød 4,  
N-3241 Sandefjord, Norway  
Made in China | [svive.gg](http://svive.gg)

